

# O.D. BASEMENT SET TRACTION MACHINES

The O.D. machine is equipped with a deflector sheave mounted on the machine to eliminate the need for an additional sheave independently supported by the building structure.

## Standard Equipment (at no extra cost)

- Direct Current Disc Brake
- Motor Coupling Bored with Keyway
- Fabricated Steel Base
- Demountable Traction Sheave
- Demountable Bronze Gear
- Steel Worm on Integral Shaft
- Motor Mounting Pads
- Customer Name on Housing
- Oiling supplies
- Demountable Deflector Sheave

## Optional Equipment:

- Drip Pans
- Mileage Recorder and Drive Assembly
- Brake Switch
- Sheave Guard
- Machine Template
- Foundation Bolts and Pipe Spacers
- Motor Mounting in Field or by H-W
- Manual Brake Release
- Drum Brake

### 3 MODELS TO CHOOSE FROM:

MACHINE	MAXIMUM SHAFT LOAD	MACHINE WEIGHT LESS MOTOR
No. 44 O.D.	20,000 Lbs.	2000 Lbs.
No. 54 O.D.	26,000 Lbs.	2700 Lbs.
No. 64 O.D.	33,000 Lbs.	3900 Lbs.

Right Hand Arrangement Shown  
Left Hand Arrangement Available

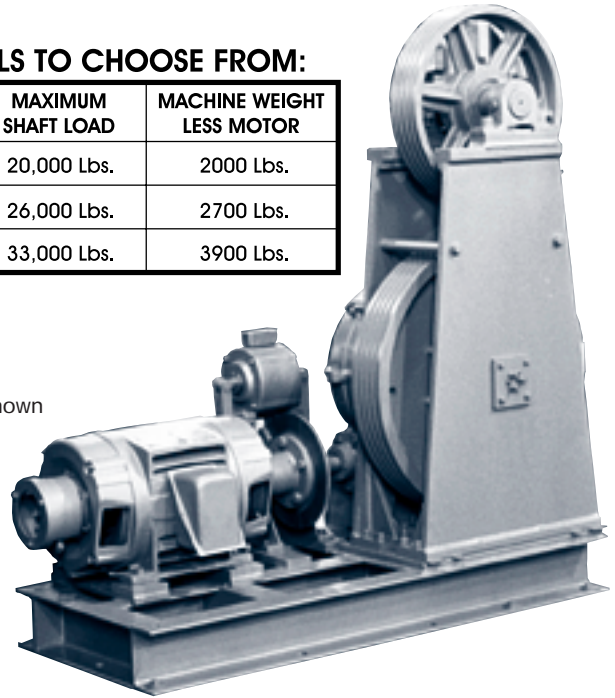

### HORSEPOWER RATINGS FOR O.D. BASEMENT SET TRACTION MACHINES\*

Capacity (LBS.)	50 FPM	75 FPM	100 FPM	125 FPM	150 FPM	200 FPM	250 FPM	300 FPM	350 FPM	400 FPM	450 FPM	500 FPM
1000	3	3	5	5	7 1/2	7 1/2	10	10	12 1/2	15	15	
1500	3	5	7 1/2	7 1/2	10	12 1/2	12 1/2	15	20	20	20	30
2000	5	7 1/2	7 1/2	10	12 1/2	15	20	20	25	25	30	40
2500	5	7 1/2	10	12 1/2	15	20	25	25	30	40	40	40
3000	7 1/2	10	12 1/2	15	15	25	30	30	40	40	50	50
3500	7 1/2	10	15	20	20	25	30	40	40	50	50	
4000	10	12 1/2	20	20	25	30	40	40	50	50		
4500	10	15	20	25	25	40	40	50	50			
5000	12 1/2	20	20	25	30	40	50	50				
6000	12 1/2	20	25	30	40	50						
7000	15	25	30	40	40	50						
8000	20	25	30	40	50							

For intermediate and higher ratings consult the H-W engineering dept.

\* All ratings are approximate, based on a 40% counterweighting, 1:1 roping, and compensation if required. Consult factory for capacity ratings not shown. Note: For leveling speeds above 30 f.p.m a larger machine or machine brake may be required.

## When Ordering O.D. Basement Set Traction Machines, Please Specify The Following:

- Rated Car Capacity • Rated Car Speed • Roping (1:1 or 2:1) • Hand of Machine
- Number & Size of Hoist Ropes • Hoist Motor Manufacturer (Motor Prints Required)
- Horsepower & R.P.M. • Power Supply • Motor Mounting in Field or by H-W
- Name to be put on Upper Housing • Other Optional Equipment

# DIMENSIONS

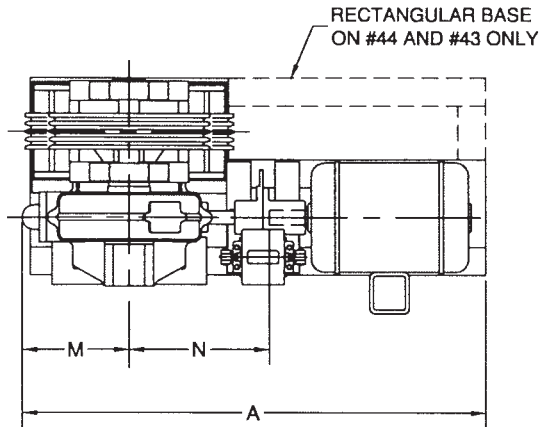
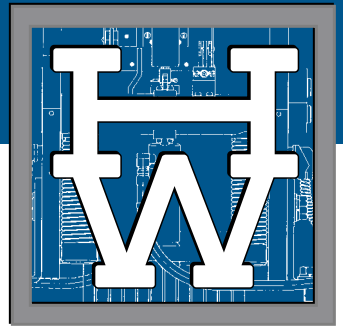

Right hand machine shown, left hand machine is symmetrically opposite.

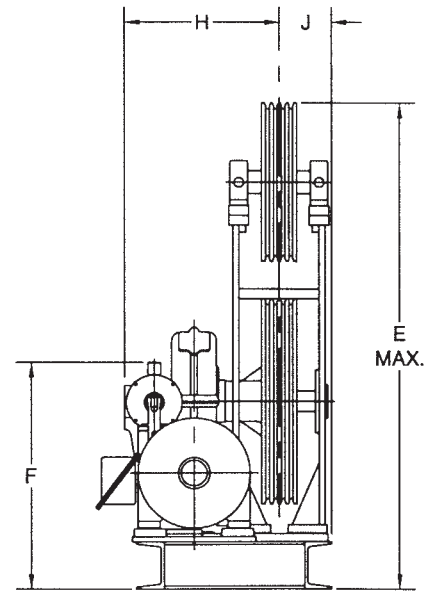
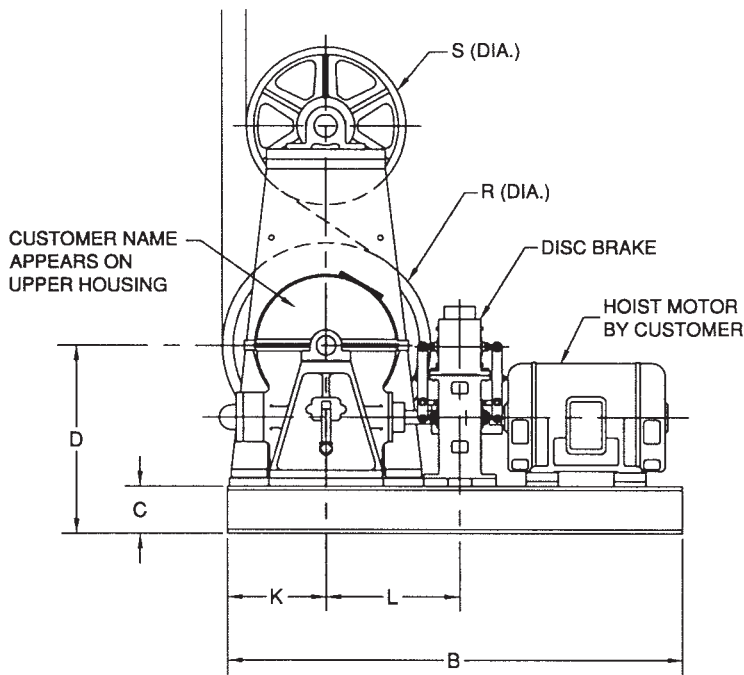

## O.D. BASEMENT SET TRACTION MACHINE DIMENSIONS

Mach.	Brake	A	B	C	D	E	F	H	J	K	L	M	N	R (Dia.)		S (Dia.)	
														Min.	Max.	Min.	Max.
#44 O.D.	#102 DISC	58 3/8	57	6	23 7/8	64 1/8	28 7/8	20	6 3/4	12 1/2	16 3/4	13 7/8	17 9/16	20	28	20	25
#43 O.D.	#90 DRUM	58 3/8	57	6	23 7/8	64 1/8	36 3/4	20	6 3/4	12 1/2	16 3/4	13 7/8	17 1/2	20	28	20	25
#54 O.D.	#102 DISC	67 1/4	62	6	26 3/4	70 7/8	30 5/8	23 3/4	7 1/8	9 1/2	15 5/8	14 3/4	17 3/4	20	30	20	25
#53 O.D.	#100 DRUM	67 1/4	62	6	26 3/4	70 7/8	39	23 3/4	7 1/8	9 1/2	19	14 3/4	19 1/2	20	30	20	25
#64 O.D.	#112 DISC	72 3/4	66	8	33 1/4	79 3/8	34 1/2	25 1/2	8 1/8	11 1/2	17 5/8	18 1/4	19 7/8	25	36	20	25
#63 O.D.	#110 DRUM	72 3/4	66	8	33 1/4	79 3/8	45	25 1/2	8 1/8	11 1/2	23 3/8	18 1/4	24 3/8	25	36	20	25