

OVERHEAD TRACTION MACHINES

Left Hand Arrangement
Shown, Right Hand
Arrangement Available

H-W offers a complete line of heavy duty traction machines with speeds up to 500 f.p.m. The smooth running efficiency of tapered roller bearings, plus the fact that each machine is thoroughly tested before shipment, insures the best possible installation at the lowest possible cost.

HORSEPOWER RATINGS FOR OVERHEAD TRACTION MACHINES*

Capacity (LBS.)	50 FPM	75 FPM	100 FPM	125 FPM	150 FPM	200 FPM	250 FPM	300 FPM	350 FPM	400 FPM	450 FPM	500 FPM
1000	3	3	5	5	7 1/2	10	10	12 1/2				
1500	3	5	7 1/2	7 1/2	10	12 1/2	12 1/2	15				
2000	5	7 1/2	10	10	12 1/2	15	20	20	25	30	30	30
2500	7 1/2	10	12 1/2	12 1/2	15	20	25	25	30	40	40	50
3000	7 1/2	10	12 1/2	15	20	25	25	30	40	40	50	50
3500	10	12 1/2	15	20	25	30	40	40	50	60	60	60
4000	10	12 1/2	20	20	25	30	40	40	50	50	60	75
4500	12 1/2	15	20	25	25	30	40	50	50	60	75	75
5000	12 1/2	20	25	30	30	40	50	50	60	75		
6000	15	20	25	30	40	50	60	60	75			
7000	20	25	30	40	40	50	60	75				
8000			40	50	50	60	75					
10000			40	50	60	75						
12000			40	50	60	75						
15000			50	75	75							
20000			75									

For Intermediate and higher ratings consult the H-W engineering dept.

* All ratings are approximate, based on a 40% counterweighting, 1:1 roping, and compensation if required. Consult factory for capacity ratings not shown. Note: For leveling speeds above 30 f.p.m a larger machine or machine brake may be required.

5 MODELS TO CHOOSE FROM:

MACHINE	MAXIMUM SHAFT LOAD	MACHINE WEIGHT LESS MOTOR
No. 34	11,000 Lbs.	1200 Lbs.
No. 44	20,000 Lbs.	1600 Lbs.
No. 54	26,000 Lbs.	2300 Lbs.
No. 64	33,000 Lbs.	3500 Lbs.
No. 74	60,000 Lbs.	5500 Lbs.

Standard Equipment:
(at no extra cost)

- Direct Current Brake: #34 thru #64 Machines Furnished with Disc Brake, #74 Furnished with Drum Brake Only
- Motor Coupling Bored with Keyway
- Fabricated Steel Base
- Demountable Traction Sheave
- Demountable Bronze Gear
- Steel Worm on Integral Shaft
- Motor Mounting Pads
- Customer Name on Housing Cover
- Oiling Supplies

Optional Equipment:

- Drip Pans
- Mileage Recorder & Drive Assembly
- Brake Switch
- Sheave Guard
- Machine Isolation Assembly (Standard or Seismic)
- Motor Mounting in Field or by H-W
- Manual Brake Release
- Drum Brake

When Ordering Overhead Traction Machines, Please Specify the Following:

- Rated Car Capacity • Rated Car Speed • Roping (1:1 or 2:1)
- Hand of Machine • Number and Size of Hoist Ropes
- Pitch of Hoist Ropes (If Deflector Exists) • Hoist Motor Manufacturer (Motor Prints Required) • Horsepower and R.P.M.
- Power Supply • Motor Mounting in Field or by H-W
- Name to be put on Upper Housing • Isolation Dimensions from Centerline of Sheave to Centerline of Beams on Either Side
- Other Optional Equipment

DIMENSIONS

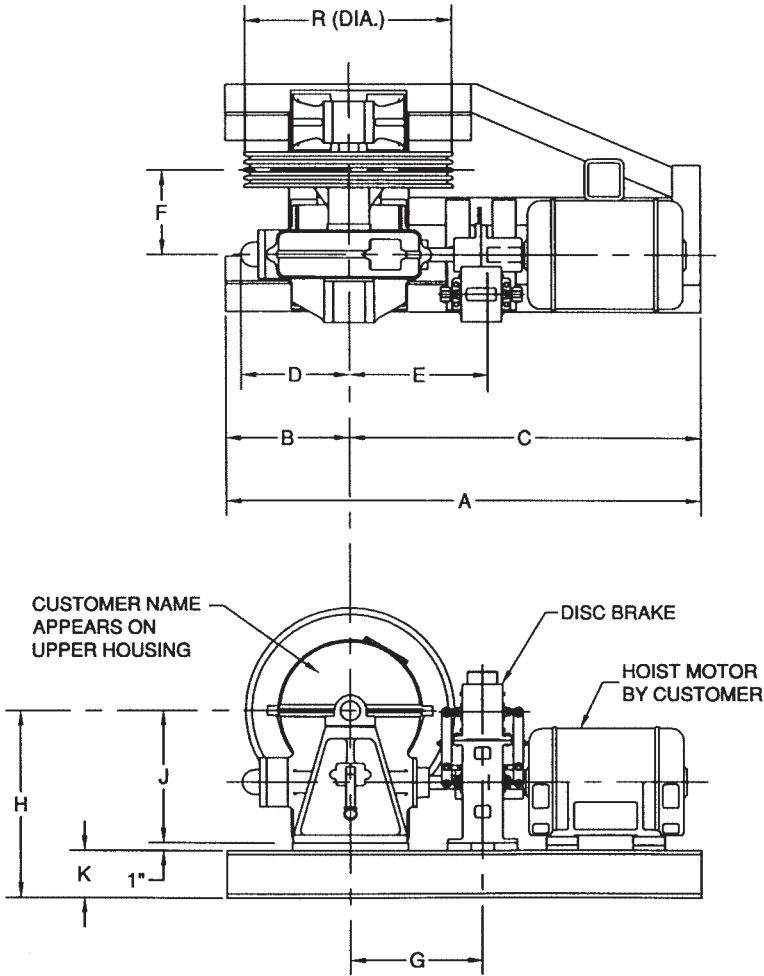
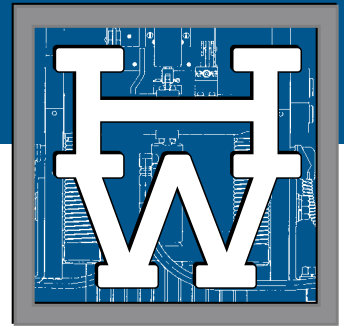

Right hand machine shown, left hand machine is symmetrically opposite.

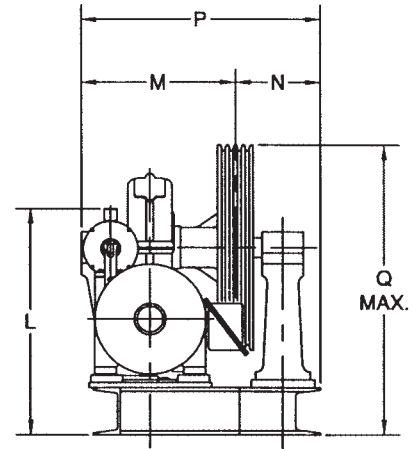

OVERHEAD TRACTION MACHINE DIMENSIONS																		
Mach.	Brake	A	B	C	D	E	F	G	H	J	K	L	M	N	P	Q	R (Dia.)	
																	Min.	Max.
#34 O.H.	#92 DISC	48	11	37	10 7/8	13 11/16	8	12	21 7/8	14 7/8	6	25 5/8	15 3/8	8 1/4	23 5/8	34 3/8	20	25
#44 O.H.	#102 DISC	60	15 1/2	44 1/2	13 7/8	17 9/16	10 3/4	16 3/4	23 7/8	16 7/8	6	28 7/8	20	10 3/4	30 3/4	37 7/8	20	28
#43 O.H.	#90 DRUM	60	15 1/2	44 1/2	13 7/8	17 3/8	10 3/4	16 3/4	23 7/8	16 7/8	6	36 3/4	20	10 3/4	30 3/4	37 7/8	20	28
#54 O.H.	#102 DISC	66	17 1/2	48 1/2	14 3/4	17 3/4	12 3/4	15 5/8	26 3/4	19 3/4	6	30 5/8	23 3/4	15	38 3/4	41 3/4	20	30
#53 O.H.	#100 DRUM	66	17 1/2	48 1/2	14 3/4	19 9/16	12 3/4	19	26 3/4	19 3/4	6	39	23 3/4	15	38 3/4	41 3/4	20	30
#64 O.H.	#112 DISC	78	20	58	18 3/8	19 7/8	13 3/8	17 5/8	33 1/4	24 1/4	8	34 1/2	25 1/2	16 1/8	41 5/8	51 1/4	25	36
#63 O.H.	#110 DRUM	78	20	58	18 3/8	24 3/8	13 3/8	23 3/8	33 1/4	24 1/4	8	45	25 1/2	16 1/8	41 5/8	51 1/4	25	36
#74 O.H.	#120 DRUM	84	20	64	19 5/16	24 3/4	18	23 3/4	40 13/16	29 13/16	10	46 5/8	31 3/4	16	47 3/4	59 13/16	32	38

No. 74 Machine is Supplied with Drum Brake Instead of Disc Type Shown