

STANDARD BASEMENT SET TRACTION MACHINES

Right Hand Arrangement
Shown, Left Hand
Arrangement Available

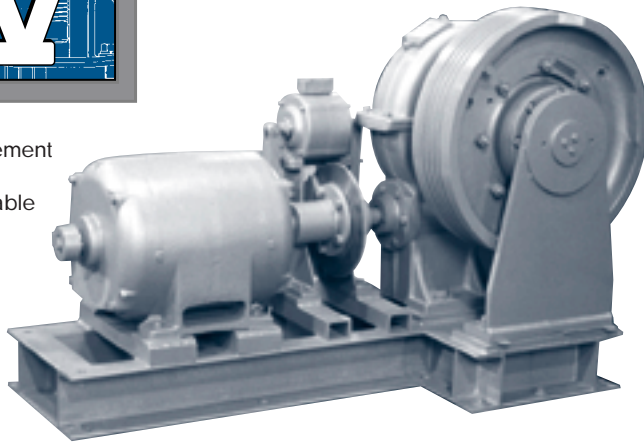

These machines are designed for installation where there is insufficient room over the hatch for an overhead machine. The Standard Basement Set Machine has a narrow steel outboard stand to allow the traction wheel to project into the hatch.

4 MODELS TO CHOOSE FROM:

MACHINE	MAXIMUM SHAFT LOAD	MACHINE WEIGHT LESS MOTOR
No. 44 B.S.	20,000 Lbs.	1600 Lbs.
No. 54 B.S.	26,000 Lbs.	2300 Lbs.
No. 64 B.S.	33,000 Lbs.	3500 Lbs.
No. 74 B.S.	60,000 Lbs.	5500 Lbs.

HORSEPOWER RATINGS FOR BASEMENT SET TRACTION MACHINES*

Capacity (LBS.)	50 FPM	75 FPM	100 FPM	125 FPM	150 FPM	200 FPM	250 FPM	300 FPM	350 FPM	400 FPM	450 FPM	500 FPM
1000	3	3	5	5	7 1/2	7 1/2	10	10	12 1/2	15	15	
1500	3	5	7 1/2	7 1/2	10	12 1/2	12 1/2	15	20	20	20	30
2000	5	7 1/2	7 1/2	10	12 1/2	15	20	20	25	25	30	40
2500	5	7 1/2	10	12 1/2	15	20	25	25	30	40	40	40
3000	7 1/2	10	12 1/2	15	15	25	30	30	40	40	50	50
3500	7 1/2	10	15	20	20	25	30	40	40	50	50	60
4000	10	12 1/2	20	20	25	30	40	40	50	50	60	75
4500	10	15	20	25	25	40	40	50	50	60	75	75
5000	12 1/2	20	20	25	30	40	50	50	60	60	75	
6000	12 1/2	20	25	30	40	50	50	60	75	75		
7000	15	25	30	40	40	50	60	75	75			
8000	20	25	30	40	50	60	75	75				
10000			40	50	60	75						
12000			50	60	75							
15000			60	75								
20000			75									

For intermediate and higher ratings consult the H-W engineering dept.

* All ratings are approximate, based on a 40% counterweighting, 1:1 roping, and compensation if required. Consult factory for capacity ratings not shown. Note: For leveling speeds above 30 f.p.m a larger machine or machine brake may be required.

When Ordering Standard Basement Set Traction Machines, Please Specify The Following:

- Rated Car Capacity • Rated Car Speed • Roping (1:1 or 2:1) • Hand of Machine • Number & Size of Hoist Ropes
- Hoist Motor Manufacturer (Motor Prints Required)
- Horsepower & R.P.M. • Power Supply • Motor Mounting in Field or by H-W • Name to be put on Upper Housing
- Other Optional Equipment

Standard Equipment (at no extra cost)

- Steel Shaft Support Block
- Narrow Steel Outboard Stand
- Direct Current Brake: #44 thru #64 Machines Furnished with Disc Brake, #74 Furnished with Drum Brake Only
- Motor Coupling Bored with Keyway
- Fabricated Steel Base
- Demountable Traction Sheave
- Demountable Bronze Gear
- Steel Worm on Integral Shaft
- Motor Mounting Pads
- Customer Name on Housing Cover
- Oiling Supplies

Optional Equipment:

- Drip Pans
- Mileage Recorder & Drive Assembly
- Brake Switch
- Sheave Guard
- Machine Template
- Foundation Bolts & Pipe Spacers
- Motor Mounting in Field or by H-W
- Manual Brake Release
- Drum Brake

DIMENSIONS

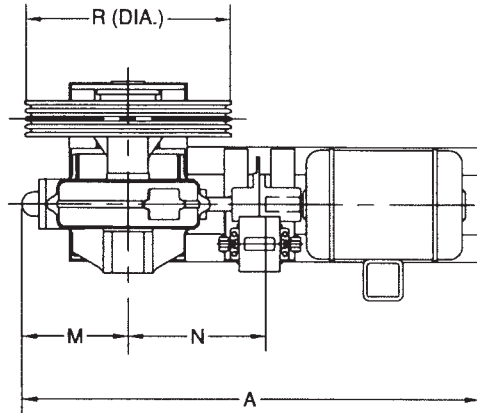
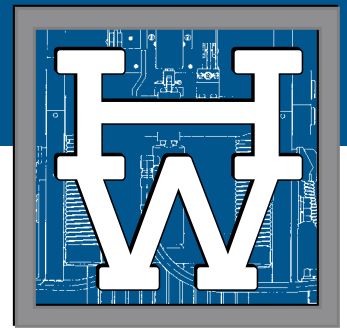

Right hand machine shown, left hand machine is symmetrically opposite.

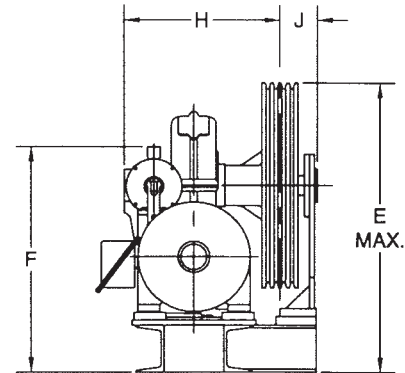
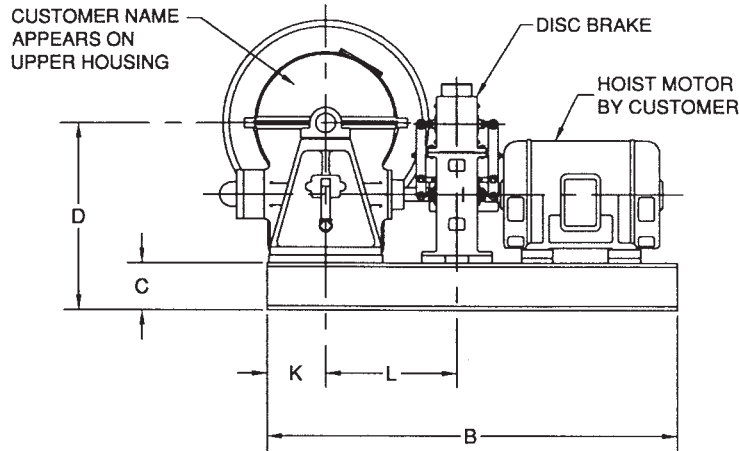

BASEMENT SET TRACTION MACHINE DIMENSIONS															
Mach.	Brake	A	B	C	D	E	F	H	J	K	L	M	N	R (Dia.)	
														Min.	Max.
#44 B.S.	#102 DISC	58 3/8	52	6	23 7/8	37 7/8	28 7/8	20	5	7 1/2	16 3/4	13 7/8	17 9/16	20	28
#43 B.S.	#90 DRUM	58 3/8	52	6	23 7/8	37 7/8	36 3/4	20	5	7 1/2	16 3/4	13 7/8	17 3/8	20	28
#54 B.S.	#102 DISC	63 1/4	58	6	26 3/4	41 3/4	30 5/8	23 3/4	6 1/4	9 1/2	15 5/8	14 3/4	17 3/4	20	30
#53 B.S.	#100 DRUM	63 1/4	58	6	26 3/4	41 3/4	39	23 3/4	6 1/4	9 1/2	19	14 3/4	19 9/16	20	30
#64 B.S.	#112 DISC	73 1/4	66	8	33 1/4	51 1/4	34 1/2	25 1/2	7 3/4	11	17 5/8	18 1/4	19 7/8	25	36
#63 B.S.	#110 DRUM	73 1/4	66	8	33 1/4	51 1/4	45	25 1/2	7 3/4	11	23 3/8	18 1/4	24 3/8	25	36
#74 B.S.	#120 DRUM	82 13/16	76	10	40 13/16	59 13/16	46 5/8	31 3/4	10	12 1/2	23 3/4	19 5/16	24 3/4	32	38

No. 74 Machine is Supplied with Drum Brake Instead of Disc Type Shown