

The Hollister-Whitney Type "B" Flexible Guide Clamp Safety is Superior in Construction and Offers Many Important Features:

- Designed in compliance with all requirements of ASME A17.1 code
- Stopping force automatically exerted equally on both sides of each guide rail and readily adjustable through compression spring on each safety block
- Full swivel of rail grips provides full and uniform contact on all rail faces when safety is actuated
- Simple mounting under plank channels spaced for stile members of any size
- All operating linkage is adjustable and located under the car for easy installation, inspection, and maintenance from elevator pit
- Car safety switch operated by linkage under the car and automatically resets
- Arranged for mounting guide shoes of any type
- Dusttight, watertight, and explosionproof switches available at an additional charge

All H-W car guide shoes, except #377, bolt directly to #480 safety. Other manufacturer's shoes may require adapter plates.

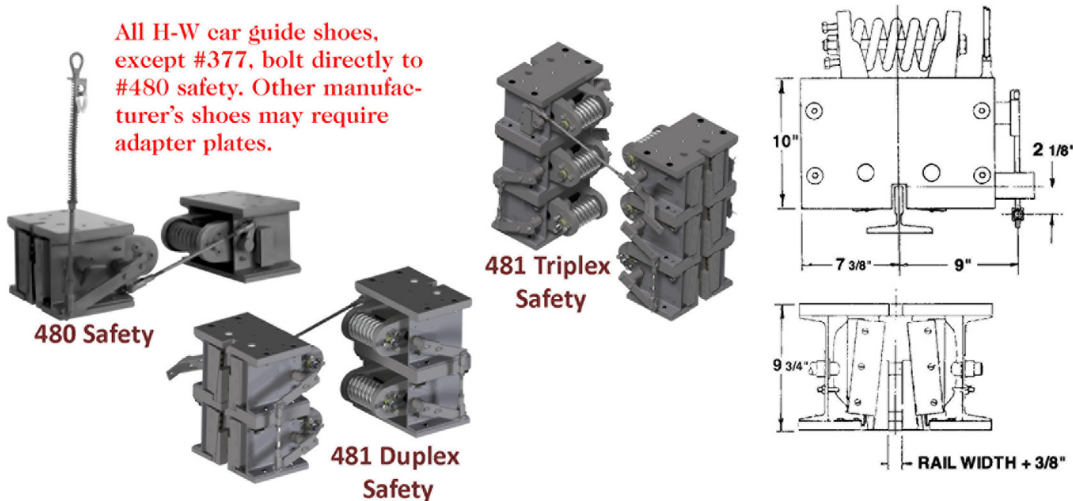

MODEL	480		481		481 DUPLEX		481 TRIPLEX
MAXIMUM LOAD (LBS) = CAR + CAPACITY + COMPENSATION	15000	13000	20000	18000	30000	40000	50000
MAXIMUM CAR SPEED (FPM)	500	800	500	800	500	350	400
MAXIMUM TRIPPING SPEED (FPM)	625	970	625	970	625	452	510
RAIL SIZES	All except 8 lb.		18.5, 22.5, & 30 lb.				30 lb. only
MINIMUM PULL THROUGH (LBS)	100			125		150	
SHIPPING WEIGHT (LBS)	400			800		1200	

NOTE: ALL MODELS, INCLUDING THOSE DESIGNED TO BE USED IN HIGHER SPEED APPLICATION, MEET ASME CODE A17.1 REQUIREMENTS. IN ADDITION, MODEL #480, FOR 500 F.P.M. AND BELOW, IS APPROVED FOR VA., G.S.A. AND STATES OF CALIFORNIA, PENNSYLVANIA, AND WISCONSIN. ALSO, MODEL #481, FOR 500 F.P.M. AND BELOW, IS APPROVED FOR STATES OF PENNSYLVANIA AND WISCONSIN.

When Ordering Safeties, Please Specify The Following:

- Car Speed • Face to Face of Guide Rails • Rail Size • Governor Location • Stile Size
- Type of Guide Shoes to be Used • Gross Load (*Empty Car Weight & Capacity*)

Safeties

Choose the Hollister-Whitney Type "A" Instantaneous Safety for these important features:

- Designed in compliance with all requirements of ASME A17.1 code
- Stopping force exerted equally on both sides of each guide rail
- Simple mounting under plank channels spaced for 6", 7", & 8" stile members
(Adapter plates available for other stile widths)
- All operating linkage is adjustable and located under the car for easy installation, inspection, and maintenance from elevator pit
- Car safety switch operated by linkage under the car – manually reset for maximum safety
- Arranged for mounting guide shoes of any type
- Dusttight, watertight, and explosionproof switches available at an additional charge

Shoe assemblies #371 and #381 will mount to #540 safety without needing adapter plates. All other shoes require adapter plates.

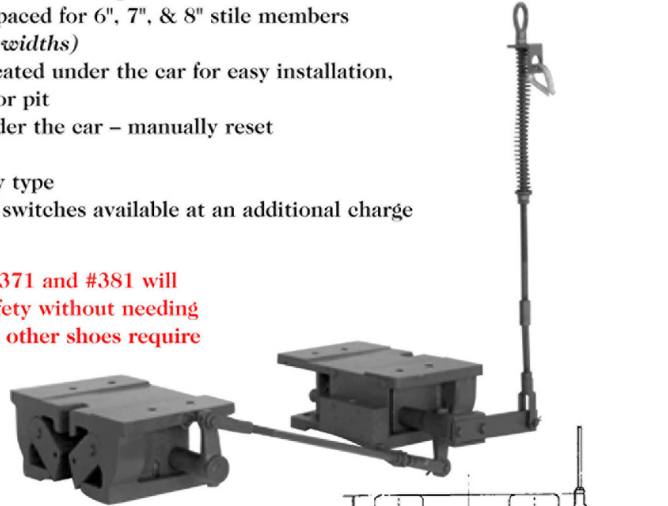

MODEL	540
MAXIMUM LOAD (LBS) = CAR + CAPACITY + COMPENSATION	20,000
MAXIMUM CAR SPEED (FPM)	150
MAXIMUM TRIPPING SPEED (FPM)	210
RAIL SIZES	8, 11, 12, 15, 18.5 & 22.5 lb.
MINIMUM PULL THROUGH (LBS)	75
SHIPPING WEIGHT (LBS)	175

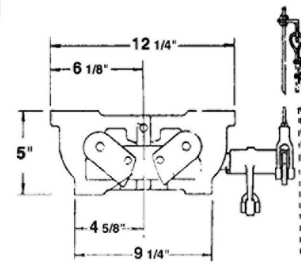
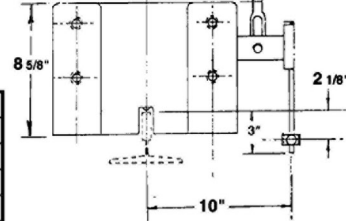

When Ordering Safeties, Please Specify the Following:

- Car Speed • Face to Face of Guide Rails
- Rail Size • Governor Location
- Stile Size • Type of Guide Shoes to be Used